

INTERGRATED LOUVERS SERIES 1000

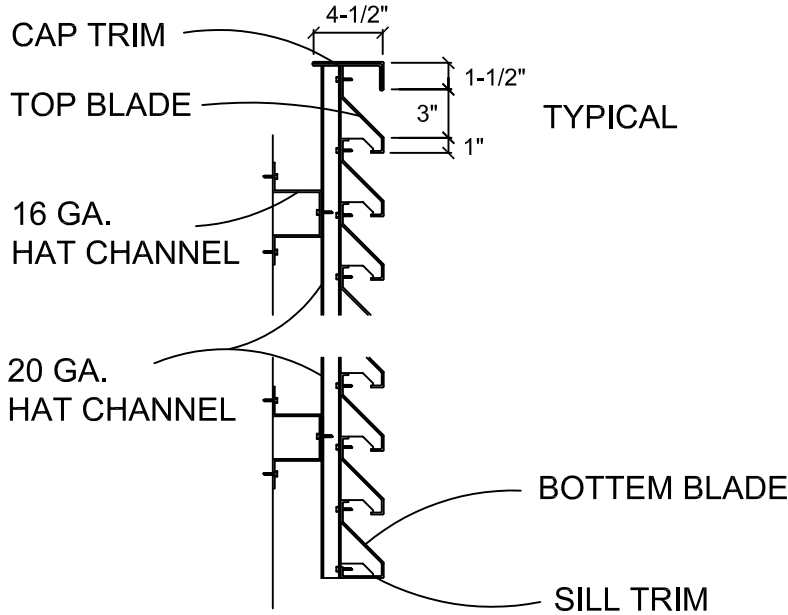

MATERIAL OPTIONS

COIL-COATED STEEL
 COIL-COATED ALUMINUM
 ARCHITECTURAL GRADE SHEET COPPER
 ANODIZED ALUMINUM
 STAINLESS STEEL
 BRONZE
 GALVALUME

FINISH OPTIONS

PAINTING:
 HYLAR 5000/KYNAR, MODIFIED POLYESTERS,
 AND OTHER CUSTOM OR EXOTIC FINISHES CAN
 BE COILCOATED OR SPRAY APPLIED.

ANODIZING
 CLEARS, BRONZES, AND VARIOUS OTHER COLORS
 CAN BE COIL ANODIZED FOR COLOR CONSISTENCY.

FABRICATION OPTIONS

STEEL	26-20 GAUGE
ALUMINUM	.032"- .040"
COPPER	16&20 OZ.
MINIMUM LENGTH	30"
MAXIMUM LENGTH	300"
INTERGRATES WITH SERIES 2000 (INTERGRATED LOUVERS)	

MECHANICAL FINISHES
 PROVIDES A SURFACE TEXTURE BY MECHANICAL
 MEANS ALONE. EMBOSSING PATTERNS ARE
 CURRENTLY AVAILABLE.

CUSTOM COLORS
 WE CAN PROVIDE FULL CUSTOM COLOR SERVICES TO
 MATCH PRACTICALLY ANY MATERIAL, SHADE, OR TINT
 YOU REQUEST.

NOTES:

1. HEAVIER GAUGES, NARROWER WIDTHS, AND EMBOSSING MINIMIZE "OIL CANNING".
2. OIL CANNING IS NOT A CAUSE FOR REJECTION.
3. ROOF SYSTEMS ARE PACKAGED IN METAL CRATES TO MINIMIZE FREIGHT DAMAGE.
4. AN EXTENSIVE SELECTION OF ASSOCIATED PANELS FLASHINGS AND TRIMS ARE AVAILABLE.

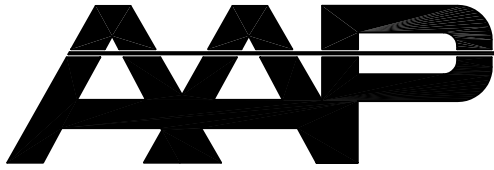

INTERGRATED LOUVERS SERIES 2000

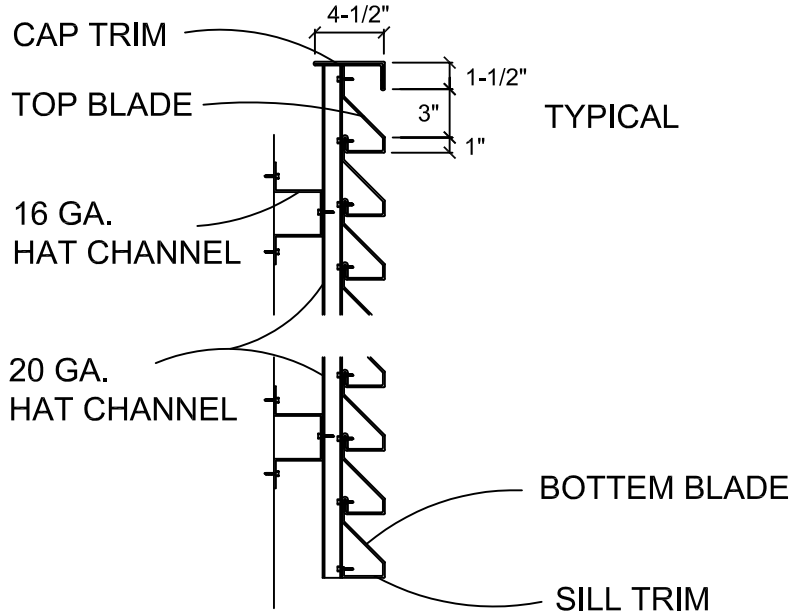

MATERIAL OPTIONS

COIL-COATED STEEL
 COIL-COATED ALUMINUM
 ARCHITECTURAL GRADE SHEET COPPER
 ANODIZED ALUMINUM
 STAINLESS STEEL
 BRONZE
 GALVALUME

FINISH OPTIONS

PAINTING:
 HYLAR 5000/KYNAR, MODIFIED POLYESTERS,
 AND OTHER CUSTOM OR EXOTIC FINISHES CAN
 BE COILCOATED OR SPRAY APPLIED.

ANODIZING
 CLEARS, BRONZES, AND VARIOUS OTHER COLORS
 CAN BE COIL ANODIZED FOR COLOR CONSISTENCY.

FABRICATION OPTIONS

STEEL	26-20 GAUGE
ALUMINUM	.032"-.040"
COPPER	16&20 OZ.
MINIMUM LENGTH	30"
MAXIMUM LENGTH	300"
INTERGRATES WITH SERIES 1000 (INTERGRATED LOUVERS)	

MECHANICAL FINISHES
 PROVIDES A SURFACE TEXTURE BY MECHANICAL
 MEANS ALONE. EMBOSING PATTERNS ARE
 CURRENTLY AVAILABLE.

CUSTOM COLORS
 WE CAN PROVIDE FULL CUSTOM COLOR SERVICES TO
 MATCH PRACTICALLY ANY MATERIAL, SHADE, OR TINT
 YOU REQUEST.

NOTES:

1. HEAVIER GAUGES, NARROWER WIDTHS, AND EMBOSING MINIMIZE "OIL CANNING".
2. OIL CANNING IS NOT A CAUSE FOR REJECTION.
3. ROOF SYSTEMS ARE PACKAGED IN METAL CRATES TO MINIMIZE FREIGHT DAMAGE.
4. AN EXTENSIVE SELECTION OF ASSOCIATED PANELS FLASHINGS AND TRIMS ARE AVAILABLE.

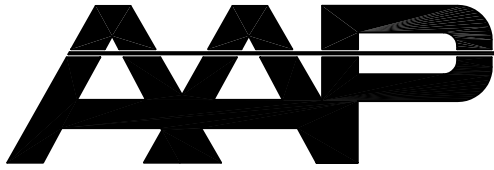

INTERGRATED LOUVERS SERIES 3000

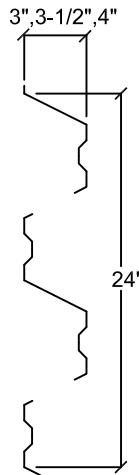

MATERIAL OPTIONS

COIL-COATED STEEL
COIL-COATED ALUMINUM
ARCHITECTURAL GRADE SHEET COPPER
ANODIZED ALUMINUM
STAINLESS STEEL
BRONZE
GALVALUME

FINISH OPTIONS

PAINTING:
HYLAR 5000/KYNAR, MODIFIED POLYESTERS,
AND OTHER CUSTOM OR EXOTIC FINISHES CAN
BE COILCOATED OR SPRAY APPLIED.

ANODIZING
CLEARS, BRONZES, AND VARIOUS OTHER COLORS
CAN BE COIL ANODIZED FOR COLOR CONSISTENCY.

FABRICATION OPTIONS

STEEL	26-20 GAUGE
ALUMINUM	.032"-.040"
COPPER	16&20 OZ.
MINIMUM LENGTH	30"
MAXIMUM LENGTH	300"
INTERGRATES WITH SERIES 600 (EXPOSED FASTENER)	

MECHANICAL FINISHES
PROVIDES A SURFACE TEXTURE BY MECHANICAL
MEANS ALONE. EMBOSING PATTERNS ARE
CURRENTLY AVAILABLE.

CUSTOM COLORS
WE CAN PROVIDE FULL CUSTOM COLOR SERVICES TO
MATCH PRACTICALLY ANY MATERIAL, SHADE, OR TINT
YOU REQUEST.

NOTES:

1. HEAVIER GAUGES, NARROWER WIDTHS, AND EMBOSING MINIMIZE "OIL CANNING".
2. OIL CANNING IS NOT A CAUSE FOR REJECTION.
3. ROOF SYSTEMS ARE PACKAGED IN METAL CRATES TO MINIMIZE FREIGHT DAMAGE.
4. AN EXTENSIVE SELECTION OF ASSOCIATED PANELS FLASHINGS AND TRIMS ARE AVAILABLE.